

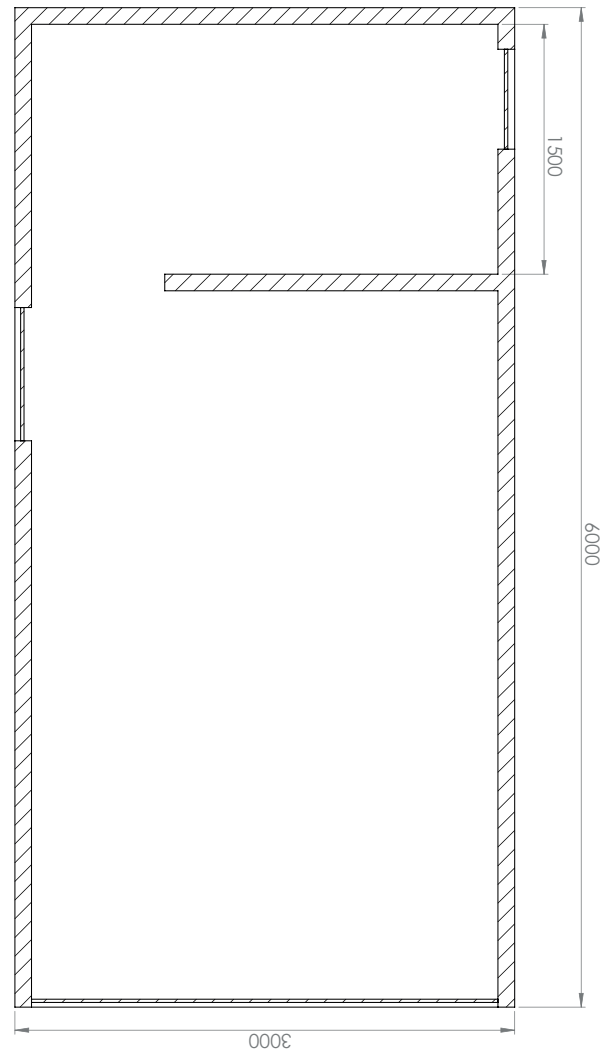

34 825€

1 BEDROOM | 1 BATHROOM

- HOUSE STRUCTURE
- VINYL PLANK FLOORING (WATER RESISTANT)
- INTERIOR IN TRICAPA WOOD (PINE WOOD)
- ELECTRICITY
- WATER AND SEWAGE SYSTEM
- GENERAL LED LIGHTNING
- ANODIZED ALUMINUM WINDOWS AND DOOR
- VIROC EXTERIOR COATING



MODEL YEAR 2022 PRICES.  
We reserve the right to modify the specifications of our models without prior notice.  
**PRICE NOT INCLUDING:** VAT or taxes, shipping & handling, insurance, handover and launching

**INTERIOR EQUIPMENT - KITCHEN**

|                                    |        |
|------------------------------------|--------|
| BASIC KITCHEN FURNITURE*           | 1 050€ |
| FRIDGE                             | 415€   |
| MICROWAVE                          | 174€   |
| BUILT-IN INDUCTION HOB (TWO-ZONE)  | 313€   |
| BUILT-IN EXTRACTOR                 | 226€   |
| DISHWASHER                         | 510€   |
| PREMIUM KITCHEN (INCLUDES ISLAND)* | 2 100€ |

\*HOME APPLIANCES NOT INCLUDED

**INTERIOR EQUIPMENT - LIVING AND DINING ROOM**

|                                |        |
|--------------------------------|--------|
| DINING TABLE AND CHAIRS FOR 4  | 130€   |
| SOFA-BED, CENTER TABLE AND RUG | 630€   |
| PREMIUM DINING AND LIVING ROOM | 1 190€ |

**INTERIOR EQUIPMENT - BATHROOM**

|  |        |
|--|--------|
| WASHSTAND, SHOWER, TOILET AND A MIRROR | 1 500€ |
|--|--------|

DECOR ITEMS (LIVING ROOM: ARMCHAIR, LAMP, CUSHIONS AND A PLANT; BEDROOM: MIRROR, QUILT COVER, LAMP AND RUG; BATHROOM: 3 PIECE BATH SET, ROLL HOLDER, WASTE BIN, TOILET BRUSH, BASKETS AND TOWEL HOLDER)

**ELECTRIC CIRCUIT**

|                                   |      |
|-----------------------------------|------|
| SOLAR PANELS ON ROOFTOP 340w EACH | 789€ |
|-----------------------------------|------|

**SOLAR PROTECTION**
**BLACKOUT**

|                                 |        |
|---------------------------------|--------|
| BLACKOUT SYSTEM FOR BEDROOM     | 1 392€ |
| BLACKOUT SYSTEM FOR LIVING ROOM | 1 392€ |

**CURTAINS**

|                                   |        |
|-----------------------------------|--------|
| CURTAINS FOR BEDROOM              | 1 624€ |
| CURTAINS FOR LIVING ROOM          | 1 624€ |
| CURTAINS BLACKOUT FOR BEDROOM     | 2 088€ |
| CURTAINS BLACKOUT FOR LIVING ROOM | 2 088€ |

**INTERIOR EQUIPMENT**
**BEDROOM**

|   |        |
|---|--------|
| DOUBLE BED WITH MATTRESS 1.6x2m         | 969€   |
| BUNK BED (INCLUDES MATTRESSES)          | 715€   |
| FOLDABLE BUNK BED (INCLUDES MATTRESSES) | 1 500€ |
| WALL MOUNTED CABINET (120CM LONG)       | 300€   |
| EXTRA CABINET (60CM LONG)               | 150€   |

**AIR CONDITIONING AND HEATING**

|                                  |        |
|----------------------------------|--------|
| AIR CONDITIONING 12.000BTU SPLIT | 2 126€ |
|----------------------------------|--------|

**DELIVERY**

|           |     |
|-----------|-----|
| TRANSPORT | TBD |
|-----------|-----|

NOTE: KITCHEN AND LIVING/DINING OPTIONS ONLY AVAILABLE UPON VALIDATION.

**CONTACT WATERLILY BOATS TEAM:**  
ZONA INDUSTRIAL DE VAGOS, LOTE 90  
3840-385 VAGOS | PORTUGAL

+351 234 036 585 | GERAL@WLBOATS.PT